



FUTURE MOBILITY HEALTHCARE INC.

DIVISION OF ABF MFG GROUP INC.
WWW.FUTUREMOBILITY.CA



ORION II

TEL: 905-671-1661
FAX: 905-671-3377
orderdesk@futuremobility.ca

Account Information

Account #: _____
Business Name: _____
Ship to Address: _____
Contact: _____
Tag For: _____

Order Date: _____
P.O.# _____
Phone: _____
City: _____
Province: _____ Postal Code: _____

1 FRAME TYPE ADP

<input type="checkbox"/> Orion II	WMA5FM005	101	\$2,700
<input type="checkbox"/> Power Tilt	WMA5FM005	101MA31	\$2,000

2 FRAME FINISH

<input type="checkbox"/> Black		101C01	No Charge
<input type="checkbox"/> Silver		101C02	No Charge
Custom Colours			
<input type="checkbox"/> Blue		101C03	\$150
<input type="checkbox"/> Green		101C04	\$150
<input type="checkbox"/> Orange		101C05	\$150
<input type="checkbox"/> Purple		101C06	\$150
<input type="checkbox"/> Red		101C07	\$150
<input type="checkbox"/> Yellow		101C08	\$150
<input type="checkbox"/> Custom Colours		101C17	\$150

3 SEAT WIDTH ADP

<input type="checkbox"/> 15"		101SW15	No Charge
<input type="checkbox"/> 16"		101SW16	No Charge
<input type="checkbox"/> 17"		101SW17	No Charge
<input type="checkbox"/> 18"		101SW18	No Charge
<input type="checkbox"/> 19"	WAMA	101SW19	No Charge
<input type="checkbox"/> 20"	WAMA	101SW20	No Charge
<input type="checkbox"/> 21" (Weight Limit 350 lbs)	WAMA	101SW21HD1	\$475
<input type="checkbox"/> 22" (Weight Limit 350 lbs)	WAMA	101SW22HD1	\$475
<input type="checkbox"/> 23" (Weight Limit 350 lbs)	WAMA	101SW23HD1	\$685
<input type="checkbox"/> 24" (Weight Limit 350 lbs)	WAMA	101SW24HD1	\$685

4 SEAT DEPTH ADP

<input type="checkbox"/> 15"		101SD15	No Charge
<input type="checkbox"/> 16"		101SD16	No Charge
<input type="checkbox"/> 17"		101SD17	No Charge
<input type="checkbox"/> 18"		101SD18	No Charge
<input type="checkbox"/> 19"	WAMB	101SD19	No Charge
<input type="checkbox"/> 20"	WAMB	101SD20	\$110
<input type="checkbox"/> 21"	WAMB	101SD21	\$225
<input type="checkbox"/> 22"	WAMB	101SD22	\$225
<input type="checkbox"/> 23"	WAMB	101SD23	\$225
<input type="checkbox"/> 24"	WAMB	101SD24	\$225

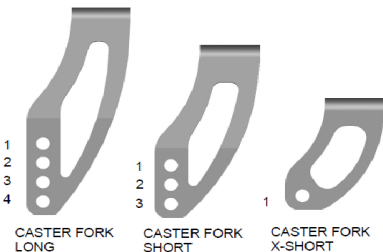

Standard Features:

- Tilt Function (45 Degrees)
- Steel Frame of your choice
- Canes and Stroller Bar
- Anti-tippers
- Seat to Floor
- Rear Wheels
- Casters
- Multi Adjustable Axle Plate
- 70° Front Rigging w/aluminum flip up footplate
- Heel Loops
- Push to Lock Wheel Locks
- Aluminum Seat Pan
- Two way Padded, Contoured Headrest
- T-Style Height Adjustable Full Length Gel
- Choice of 2 colours - Black or Silver

5 SEAT-TO-FLOOR HEIGHT (up to 350 lbs. weight capacity)

<input type="checkbox"/> 13.25" (20" Wheels and 4" Casters)	101STF01	\$225
<input type="checkbox"/> 13.25" (16" Wheels and 4" Casters)	101STF97	No Charge
<input type="checkbox"/> 14.5" (20" rear and 5" casters)	101STF02	No Charge
<input type="checkbox"/> 15" (20" Wheels and 5" Casters)	101STF03	No Charge
<input type="checkbox"/> 15.5" (22" Wheels and 5" Casters)	101STF25	No Charge
<input type="checkbox"/> 15.5" (12" Wheels and 6" Casters)	101STF26	\$195
<input type="checkbox"/> 16" (20" Wheels and 5" Casters)	101STF27	No Charge
<input type="checkbox"/> 16" (12" Wheels and 6" Casters)	101STF28	\$195
<input type="checkbox"/> 16" (24" Wheels and 6" Casters)	101STF29	No Charge
<input type="checkbox"/> 16" (22" Wheels and 6" Casters)	101STF06	No Charge
<input type="checkbox"/> 16 1/2" (24" Wheels and 6" Casters)	101STF30	No Charge
<input type="checkbox"/> 16 1/2" (24" Wheels and 7" Casters)	101STF31	No Charge
<input type="checkbox"/> 16 1/2" (22" Wheels and 7" Casters)	101STF08	No Charge
<input type="checkbox"/> 17" (24" Wheels and 7" Casters)	101STF32	No Charge
<input type="checkbox"/> 17" (22" Wheels and 8" Casters)	101STF33	No Charge
<input type="checkbox"/> 18" (16" Wheels and 8" Casters)	101STF10	Standard
<input type="checkbox"/> 18" (24" Wheels and 8" Casters)	101STF11	Standard
<input type="checkbox"/> 19" (24" Wheels and 8" Casters) 1" Spacer	101STF34	No Charge
<input type="checkbox"/> 20" (24" Wheels and 8" Casters) 2" Spacer	101STF35	\$110

ORION II FRONT SEAT TO FLOOR HEIGHT MATRIX

FRONT STF	CASTER	FORK HOLE	STEM LENGTH		FRONT STF	REAR WHEEL	AXEL POS.
13.25	4"	1	X-SHORT	SUPER LOW	13.25	20"	SUPER LOW
14.5	5"	1	SHORT		13.25	16"	2
15.0	5"	2	SHORT		14.5	20"	1
15.5	5"	3	SHORT		14.5	16"	3
16.0	6"	3	SHORT	AXEL POSITIONS	15.0	20"	2
16.5	7"	3	SHORT		15.5	22"	1
16.0	5"	3	LONG		15.5	12"	4
16.5	6"	3	LONG		16.0	24"	1
17.0	7"	3	LONG		16.0	22"	2
17.0	7"	3	LONG		16.0	20"	3
17.0	8"	3	LONG		16.0	12"	4
18.0	8"	4	LONG		16.5	24"	1
* 19.0	8"	4	LONG		16.5	22"	2
** 20.0	8"	4	LONG		16.5	24"	1
					17.0	24"	2
					17.0	22"	3
				18.0	16"	4	
				* 18.0	24"	3	
				** 19.0	24"	3	
				** 20.0	24"	3	

* 1" RISER BLOCK REQUIRED
** 2" RISER BLOCK REQUIRED

FOOTNOTES:

- A. Heavy Duty Package consisting of gusseted frame.
- B. Quick release axles are used on 23"-24" wide chairs.
- C. Only available with pull to lock brakes.
- D. With 12" rear wheel you can only have push to lock brakes.
- R. Add 9.5" to seat width of chair on finished product (handrim to handrim).

M. Weight Capacity of Orion II with Power Tilt is 250 lbs. Power Tilt can only be placed on Orion II chairs with seat width of 15" to 20" Power Tilt provides approximately 42° of infinite tilt (3° to 45°). Includes: 2 Button Hand Control

6 REAR WHEEL RIM

<input type="checkbox"/> Mag Wheels	101RW09	No Charge
<input type="checkbox"/> Spoke Wheels	101RW10	\$75

7 REAR WHEEL TIRE

<input type="checkbox"/> Airless (Solid Rubber)	101RT1	Standard
<input type="checkbox"/> Pneumatic	101RT2	No Charge

8 HANDRIM OPTIONS

ADP

<input type="checkbox"/> Chrome	101HR1	Standard
<input type="checkbox"/> Plastic Coated	WAMO 101HR2	\$160
<input type="checkbox"/> Omit Handrims	101HR3	No Charge

9 ARM TYPE

<input type="checkbox"/> T-Style Adjustable Height	101AR04	Standard
<input type="checkbox"/> T-Style Adjustable Height Pin Release - Youth	101AR05	\$280
<input type="checkbox"/> T-Style Adjustable Height Pin Release - Adult	101AR06	\$300
<input type="checkbox"/> T-Style Fixed Height	101AR02	\$250
<input type="checkbox"/> Flip Back Adjustable Height	101AR10	\$225
<input type="checkbox"/> 2-point Fixed Height Heavy Duty Arm	101AR13	\$250

Armrest Matrix for T-Style Pin Release Arm

Armrest Style	Transfer Tube Length D1	Arm Guard Length D2	H Range
Adult	6.75"	7.50"	9.50" - 14.50"
Youth	4.50"	5.0"	8.75" - 13.75"

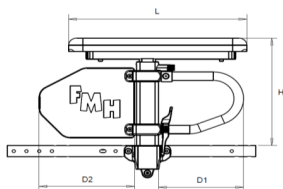

Arm Pad Length L		
Desk	Full	Curved
10.25"	14.0"	17.0"

10 ARM PAD

<input type="checkbox"/> Desk length Vinyl 10" (pair)	101AP1	No Charge
<input type="checkbox"/> Full length Vinyl 14" (pair)	101AP2	No Charge
<input type="checkbox"/> Contour Gel 17" (pair)	101AP3	Standard
<input type="checkbox"/> Contour Gel Wide 16" (pair)	101AP4	\$150

11 PUSH OPTIONS

ADP

<input type="checkbox"/> Canes & Stroller Bars Fixed Low	101SP1	Standard
<input type="checkbox"/> Canes & Stroller Bars Fixed High	101SP2	No Charge
<input type="checkbox"/> Canes & Stroller Bars Fold Down Low	101SP3	\$250
<input type="checkbox"/> Canes & Stroller Bars Fold Down High	101SP4	\$250
<input type="checkbox"/> Stroller Bars Adjustable Hinged (16"-20" Width Adj.)	101SH5	\$300
<input type="checkbox"/> Stroller Bars Adjustable Hinged (20"-24" Width Adj.)	101SH6	\$300
<input type="checkbox"/> Stroller Bars Fixed Low	101SH1	\$150
<input type="checkbox"/> Stroller Bars Fixed High	101SH2	\$150
<input type="checkbox"/> Stroller Bars Adjustable Angle Fold Down Low	101SH3	\$250
<input type="checkbox"/> Stroller Bars Adjustable Angle Fold Down High	101SH4	\$250
<input type="checkbox"/> Back Cane Angle (83°, 90°, 97°, 104°, 111°) Specify _____	101BA1	No Charge

Recline Options

<input type="checkbox"/> Canes & Stroller Bars Recline Low	WAMI 101SP5	\$500
<input type="checkbox"/> Canes & Stroller Bars Recline High	WAMI 101SP6	\$500
<input type="checkbox"/> Stroller Bar Recline Low	WAMI 101SP11	\$500
<input type="checkbox"/> Stroller Bar Recline High	WAMI 101SP12	\$500

12 TILT TRIGGER LOCATION

<input type="checkbox"/> Trigger Location - Push Cane <small>Side Trigger Handle not available with Adjustable Hinge Stroller.</small>	101TH1	No Charge
<input type="checkbox"/> Trigger Location - Stroller Bar	101TH2	No Charge
<input type="checkbox"/> Foot Tilt Release (Mounted onto left side)	101TH3	\$95
<input type="checkbox"/> Foot Tilt Release (Mounted onto right side)	101TH4	\$95

FOOTNOTES:

- E. Height adjustability of 4" and depth adjustability of 1".
- F. 90° Swingaway doesn't fit with 8" front caster.
- S. Pins not required for Lunar Backs.
- H. Includes Swingway Calf Pads.
- I. Not available with 7" or 8" casters when footboard is facing back on 900 swing away.
- O. Recline options cannot be used with the power tilt option.

13 BACK OPTIONS (CHOOSE ONE)

ADP

<input type="checkbox"/> Orion Back	SEBFM3005	101BK00	\$150
<input type="checkbox"/> Prism Basic Back	SEBFM0010	101BK01	\$150
<input type="checkbox"/> Prism Ultra Back	SEBFM0025	101BK06	\$250
<input type="checkbox"/> Prism Air Back	SEBFM0040	101BK11	\$400
<input type="checkbox"/> Prism TrueFitt Back	SEBFM0055	101BK16	\$650
<input type="checkbox"/> Prism Max Ultra Back	SEBFM0150	101BK21	\$300
<input type="checkbox"/> Prism Max Air Back	SEBFM0150	101BK26	\$450
<input type="checkbox"/> Prism Max TrueFitt Back	SEBFM0150	101BK31	\$700
<input type="checkbox"/> Lunar Back Mid Basic Lateral	SE0000684	101BK39	\$550

W () x H ()

Standard Back Size Height: 16", 18" and 20"

For other Backs, please fill in the required Backs Order Form and attach it to this order

14 BACK PINS

<input type="checkbox"/> Longer Pins for Back Hardware 1" Growth	101BP1	\$50
<input type="checkbox"/> Longer Pins for Back Hardware 2" Growth	101BP2	\$50

15 SEAT OPTIONS (CHOOSE ONE)

ADP

<input type="checkbox"/> Prism Ideal Cushion	SEFSM0050	101SC01	\$100
<input type="checkbox"/> Prism Elite Cushion	SEFSM0060	101SC04	\$250
<input type="checkbox"/> Prism Supreme Cushion	SEFSM0015	101SC07	\$375
<input type="checkbox"/> Prism Supreme II Plus Cushion	SEFSM0070	101SC10	\$375
<input type="checkbox"/> Prism Supreme Air Cushion	SEFSM0030	101SC13	\$500
<input type="checkbox"/> Omit Cushion		101SC20	No Charge

W () x D ()

Standard Size Cushion Depth: 16", 18" and 20"

For other Cushions, please fill in the required Cushions Order Form and attach it to this order

16 FRONT RIGGING

ADP

<input type="checkbox"/> 70° Pin Style	101FR01	Standard
<input type="checkbox"/> 80° Pin Style	101FR02	\$135
<input type="checkbox"/> 60° Swingaway Upgraded	101FR03	\$215
<input type="checkbox"/> 70° Swingaway Upgraded	101FR04	\$215
<input type="checkbox"/> 90° Swingaway Upgraded	101FR05	\$230
<input type="checkbox"/> Elevating Legrest (pair)	WAMK 101FR10	\$550
<input type="checkbox"/> Omit Front Rigging	101FR11	No Charge
<input type="checkbox"/> Omit Footrest Hanger	101FR12	No Charge

17 FOOTPLATE TYPE

ADP

<input type="checkbox"/> Composite Flip Up Small	101FP01	No Charge
<input type="checkbox"/> Composite Flip Up Large	101FP03	No Charge
<input type="checkbox"/> Aluminum Flip Up Small	101FP05	Standard
<input type="checkbox"/> Aluminum Flip Up Medium	101FP06	Standard
<input type="checkbox"/> Aluminum Flip Up Large	101FP07	Standard
<input type="checkbox"/> Composite Angle Adj. Flip-Up Spring Return Large	WAMJ 101FP04	\$150
<input type="checkbox"/> Composite Angle Adj. Flip-Up Cone Lock Large	WAMJ 101FP16	\$150
<input type="checkbox"/> Composite Angle Adj. Flip-Up Cone Lock X-Large	WAMJ 101FP17	\$170
<input type="checkbox"/> Aluminum Depth & Angle Adj. Flip-Up Small	WAMJ 101FP10	\$160
<input type="checkbox"/> Aluminum Depth & Angle Adj. Flip-Up Medium	WAMJ 101FP11	\$160
<input type="checkbox"/> Aluminum Depth & Angle Adj. Flip-Up Large	WAMJ 101FP12	\$160
<input type="checkbox"/> Alu. One Piece Flip-Up Footboard (15"-20")	101FP19	\$160
<input type="checkbox"/> Alu. One Piece Flip-Up Footboard (21"-24", Custom)	101FP20	\$195
<input type="checkbox"/> Padded One Piece Flip-Up Footboard	101FP26	\$210
<input type="checkbox"/> Alu. One-Piece Footbox Small (15"-17")	101FP30	\$200
<input type="checkbox"/> Alu. One-Piece Footbox Medium (18"-20")	101FP31	\$225
<input type="checkbox"/> Alu. One-Piece Footbox Large (21"-23")	101FP32	\$250
<input type="checkbox"/> Soft Padded Footbox 15" - 19"	101FP33	\$275
<input type="checkbox"/> Soft Padded Footbox 20" - 24"	101FP34	\$300
<input type="checkbox"/> Alu. Split Footbox Small (15"-17")	RT LT 101FP35	\$200
<input type="checkbox"/> Alu. Split Footbox Medium (18"-20")	RT LT 101FP36	\$250
<input type="checkbox"/> Alu. Split Footbox Large (21"-23")	RT LT 101FP37	\$275
<input type="checkbox"/> Alu. Split Footbox w/mounting Small (15"-17")	RT LT 101FP38	\$200
<input type="checkbox"/> Alu. Split Footbox w/mounting Medium (18"-20")	RT LT 101FP39	\$250
<input type="checkbox"/> Alu. Split Footbox w/mounting Large (21"-23")	RT LT 101FP40	\$275

