

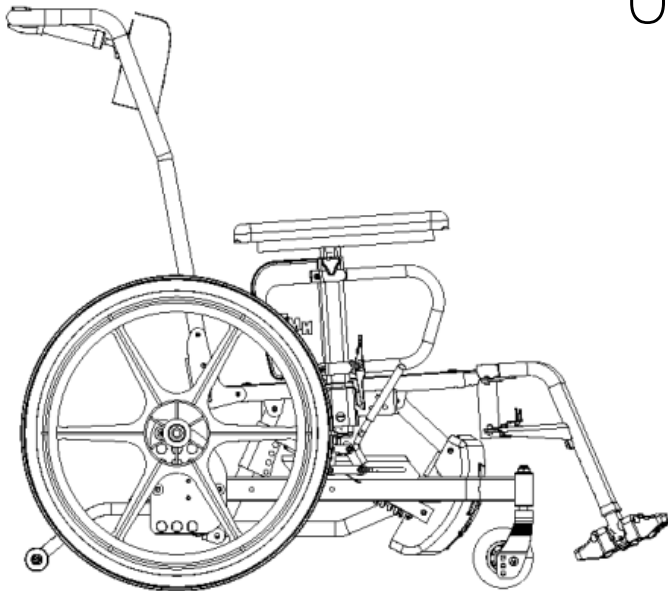

**FUTURE**  
MOBILITY HEALTHCARE INC.

**ORION**

# USER MANUAL



470 – ORION II 500 REV04 REV 12/17/2018

# Table of Contents

<b>1</b>	<b>General</b> .....	5
	Operating Safety Warnings.....	6
	Features.....	7
	Safety Inspection Checklist.....	8
	Troubleshooting.....	10
	Labels.....	11
2	T-Style Arm Rests.....	12
3	2 Point Heavy Duty Arm Rests.....	13
	Installing and removing 2-Point Heavy Duty Arm Rest [Figure 2].....	13
4	Pin Style Leg Rests.....	14
	Installing Legrest and Adjusting height of Foot Plate [Figure 3].....	14
2.	For flip-up, push and hold release lever ('A'), while lifting armrest from arm socket.....	14
5	Center Pivot Style Swingaway Legrest.....	15
	Adjusting and Installing T-Style Pin Release Armrests [Figure 4].....	15
	<b>Installing center pivot style swingaway legrest.....</b>	<b>15</b>
	<b>Adjusting foot plate height and angle.....</b>	<b>15</b>
6	Angle Adjustable Back Canes.....	16
	Adjusting the angles of back cane [Figure 5].....	16
	.....	16

## Table of Contents

7	Tilt Chair.....	17
	Using the tilt function [Figure 6].....	17
8	Adjusting Tilt Angle Settings .....	18
	Installing and adjusting center pivot dual swingaway leg rests [Figure 7].....	18
9	Rear Wheels.....	19
	Installing and uninstalling the rear wheels [Figure 8,Figure 9].....	19
10	Wheel Locks.....	21
	Applying and Adjusting Wheel Locks[Figure 10, Figure 11] .....	21
	.....	22
11	Gas Spring Settings.....	23
	Adjusting weight settings on gas springs [Figure 12, Figure 13].....	23
12	Head Rest.....	24
	Adjusting the headrest [Figure 14] .....	24
13	Casters and Forks .....	25
	Replacing and Installing Front Casters [Figure 15, Figure 16, Figure 17,Table 1] .....	25
	Installing and replacing the Casters [Figure 15].....	25
14	Anti-tippers.....	29
	Installing and adjusting the anti-tippers [Figure 18].....	29
15	Cleaning Instructions.....	31

## Table of Contents

16	Warranty.....	32
----	---------------	----

## **1 General**

**NOTICE:** Information contained within this document is subject to change without notice.

**WARNING:** DO NOT install this equipment without first reading and understanding this instruction booklet. If you are unable to understand these instructions, contact a healthcare professional, dealer or technical personnel before attempting to install this equipment - otherwise, injury or damage may occur.

**NOTE:** Check all parts for shipping damages before using. In case of damage, **DO NOT** use the equipment. Contact the Equipment Supplier for further instructions.

## Operating Safety Warnings

Please read and obey all instructions and warnings listed in this manual, ignoring these warnings could result in serious injury to the patient or attendants.

- Ensure anti-tippers are always installed in the correct position when using the wheelchair.
- **Never** lift the wheelchair by the armrests or front rigging.
- Any change of seat depth may require repositioning of the rear wheels; always test the stability of the chair before use.
- **Never** stand on the footplates during transfers in and out of the wheelchair.
- Ensure wheel locks are fully engaged while stopped on any incline/decline and while patient is transferring to and from the wheelchair.
- **Never** tilt the wheelchair on two wheels without assistance. When in any tilt or recline position, this chair must be operated by an attendant.
- **Never** use the wheel locks to stop a moving wheelchair.
- It is not recommended to transport users in vehicles of any kind while seated in the wheelchair. Do not use any kind of wheelchair Tie-Down restraints that are not approved by the ADP.

## **Features**

### FEATURES

- Tilt Function 25 degrees
- 24" – 32" wide
- 15" – 22" depth
- Fixed Height Full-Length Arms
  - 2-point Fixed
  - Height of 9-1/2"
  - Arm Location for Tray Placement
- Fixed Back Angle Adjustable (+7 to -21 deg.)
- 16-1/2" Seat to Floor
- 12", 20", 22" or 24" Rear Wheels
- 5", 6" or 8" Casters
- Multi-adjustable axle plate
- 70 degrees front rigging foot plate
- Heel Loops
- Spring Back Push to Lock Wheel Locks
- Aluminum Seat Pan
- PRISM™ Ideal Cushion
- Adjustable Orion Back
- Two-Way, Padded, Contoured Headrest
- Anti-rattle rear Anti-Tippers
- Choice of Two Colors
- User weight capacity: 500lbs

### SPECIFICATIONS

- Tilt Range: 3-28 degrees
- Fixed Back Angle Adjustment: +7 to -21 degrees
- Overall Dimensions: 26" x 18", 16-1/2" STF
- Chair Width: 35"
- Chair Length: 49" (with footboard)
- Chair Height: 39"
- Chair Weight: 70lbs (cushion, back, arm rests and riggings not included)

## **Safety Inspection Checklist**

Initial adjustments should be made to suit your personal body structure needs and preference.  
Thereafter follow these maintenance procedures:

<b>Item</b>	<b>Initially</b>	<b>Weekly</b>	<b>Monthly</b>	<b>Periodical</b>
<u>GENERAL</u>				
Wheelchair rolls straight (no excessive drag or pull to one side)	X		X	
<u>FRAME AND CROSSING TUBES</u>				
Inspect for loose or missing hardware	X			X
Inspect for bent frame or cross-tubes	X			X
<u>WHEEL LOCKS</u>				
Do not interfere with tires when rolling	X		X	
Pivot points free of wear and looseness	X		X	
Wheel locks easy to engage	X			X
Wheel locks prevent chair from moving when engaged	X	X		
<u>SEAT AND BACK</u>				
Inspect for rips or sagging	X			X
Inspect for loose or broken hardware	X		X	
Inspect cane and hand grips for wear/looseness	X		X	



<u>TIRES</u>				
Inspect for flat spots, cracks and wear Caution: as with any vehicle, the wheels and tires should be checked periodically for cracks and wear and should be replaced.	X	X		X
<u>REAR WHEELS</u>				
If equipped, quick-release axles lock properly	X	X		
No excessive side movement or binding when lifted and spun	X			X
Inspect for cracked, bent or broken spokes	X	X		
<u>HANDRIMS</u>				
Inspect for signs of rough edges or peeling	X			X
<u>FRONT CASTERS/FORKS</u>				
Inspect caster fork assembly for proper tension by spinning caster; caster should come to a gradual stop	X	X		
Adjust bearing system if wheel wobbles or binds to a stop. Ensure wheel bearings are clean and free of moisture.	X		X	X
Check stem caster journal and lock nut for tightness	X		X	
Inspect casters for cracks and wear	X	X		X
Inspect for cracked, bent or broken spokes	X			
<u>CLEANING</u>				
Clean upholstery and armrests	X			X

**Troubleshooting**

<b>Chair Veers Right/Left</b>	<b>Wheels Drift</b>	<b>Sluggish Turn or Performance</b>	<b>Caster Flutter</b>	<b>Squeaks and Rattles</b>	<b>Looseness in Chair</b>	<b>Solutions</b>
		X	X	X	X	Check for loose nuts and bolts
X	X		X			Check angle adjustable caster assembly
X	X					Check that rear wheels are equally spaced away from seat frame.

**Labels**

ORION II 500 – Heavy Duty Chair

**WARNING**  
**DO NOT OPERATE WITHOUT  
THE ANTI-TIP MECHANISM  
IN PLACE**

**WEIGHT CAPACITY**  
**500 LBS (227 kgs)**  
**REFER TO OWNER'S MANUAL**

**CAUTION**  
**MOVING THE REAR AXLE TO  
THE FORWARD POSITION MAY  
DECREASE THE STABILITY OF  
THE WHEEL CHAIR**

## 2 T-Style Arm Rests

### Installing and removing T-Style arm rests [Figure 1]

#### Installing and Removing T-Style Armrest

1. Push armrest into arm socket until lock is engaged into slot.
2. For removal, push and hold release lever ( `A'), while lifting armrest from arm socket.

#### Frame Adjustment Position

1. Remove armrest from the chair.
2. Remove the three inside bolts holding the arm socket to the seat frame ( `B').
3. Move the arm socket to the forward mounting position ( `C') and replace the three bolts ( `B').
4. Re-install the armrest in the arm socket.

#### Arm Height Adjustment

1. Loosen knob ( `D').
2. Lift armrest until desired position is acquired (ranges from 9 ½" – 14" in ½" increments).
3. "Re-tighten" knob ( `D').

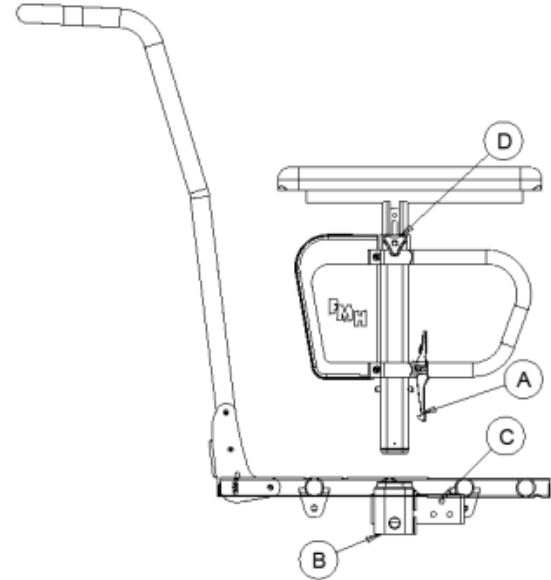

**Figure 1**

### 3 2 Point Heavy Duty Arm Rests

#### Installing and removing 2-Point Heavy Duty Arm Rest [Fig. 2]

1. Push armrest into 2-point mounting bracket until lock is engaged into hole ('B')
2. For removal, push and hold release lever ('A'), while lifting armrest from 2-point mounting plate

**Note:** The 2-point Heavy Duty Arm Rest is not adjustable in height

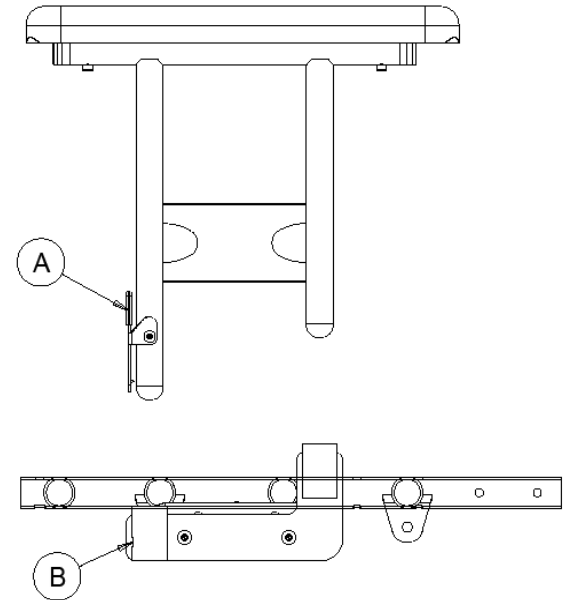

**Figure 2**

## 4 Pin Style Leg Rests

### Installing Legrest and Adjusting height of Foot Plate [Figure 3]

#### Installing and Uninstalling the Legrest

1. To engage, push armrest into arm socket until release lever ('A') is engaged into slot.
2. For flip-up, push and hold release lever ('A'), while lifting armrest from arm socket.

#### Adjusting foot plate height

1. Loosen knob ('B').
2. Lift armrest until desired position is acquired (ranges from 9 ½" - 14" in ½" increments).
3. Re-tighten" knob ('B').

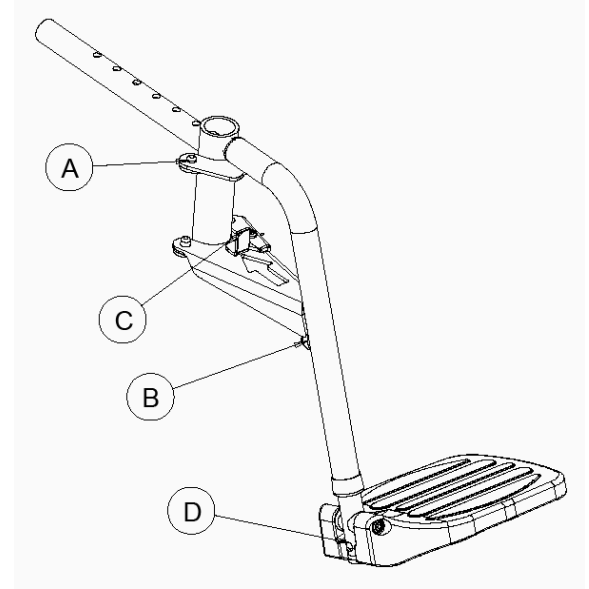

**Figure 3**

## 5 **Center Pivot Style Swingaway Legrest**

### **Adjusting and Installing T-Style Pin Release Armrests [Figure 4]**

#### **Installing center pivot style swingaway legrest**

1. Position swing-away footrest onto hanger ('A') insuring pivot plug sits flush onto hanger tube.
2. To remove footrest depress handle ('B') releasing latch ('C') and swing footrest outward.

#### **Adjusting foot plate height and angle**

1. Remove footrest bracket bolt. Slide footrest extension tube up or down to desired height.
2. "Re-install" bolt.
3. Loosen bolt ('D') to adjust footplate angle and horizontal position.
4. "Re-tighten" bolt after final adjustment

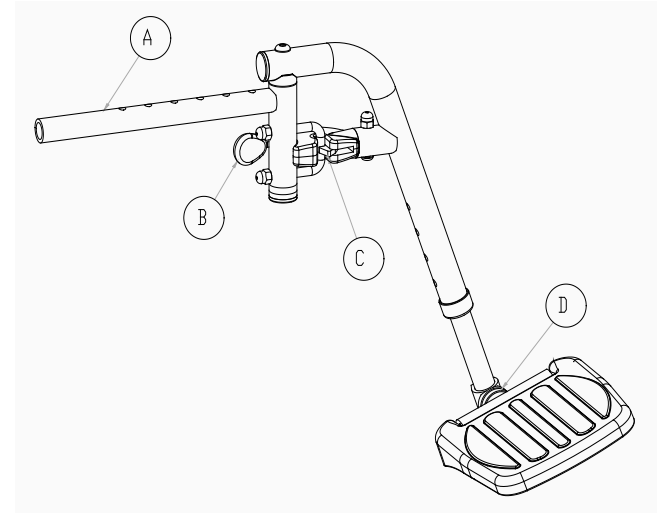

**Figure 4**

## 6 Angle Adjustable Back Canes

### Adjusting the angles of back cane [Figure 5]

Remove bolt ('A') and nut ('B') on both sides of the back post.

Rotate back cane to desired angle and insert nuts and bolts making sure covered spacers are in place. Repeat for other back post and ensure back is 'locked' in position prior to placing occupant into wheelchair.

**Note:** Manufacturer's setting is -7 degrees, with each hole representing 7 degree increments (holes range from +7 degrees to -21 degrees)

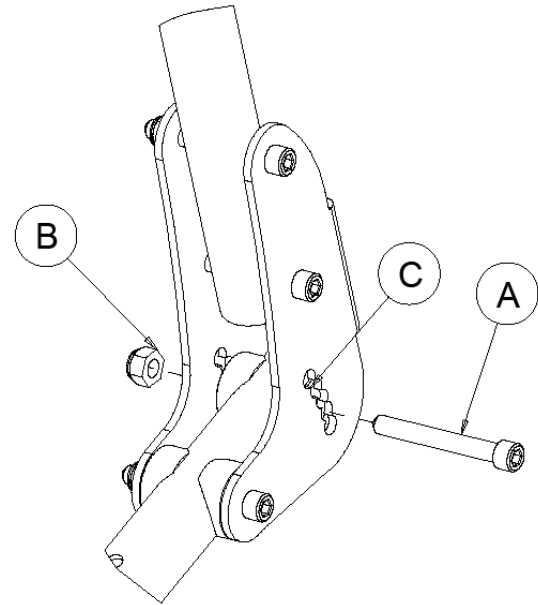

**Figure 5**



## 7 Tilt Chair

### Using the tilt function [Figure 6]

1. Grasp trigger handle ('A') with one's fingers and pull the handle upwards. The Orion II 500 wheelchair has 2 handles - 1 located on each push cane respectively or both located on the push bar.
2. The trigger handle has a cable ('B') which attaches to a heavy duty pin actuator ('C'). When the trigger handle is pulled the pin actuator causes the gas cylinder spring ('D') to compress and the wheelchair is 'unlocked' from the previous tilt angle.
3. With both handles pulled upwards, the attendant can change the tilt angle of the wheelchair to the desired angle and then release the trigger handles. The wheelchair should 'lock' in position. After tilting ensure the wheelchair is stable to prevent injury to the end user.

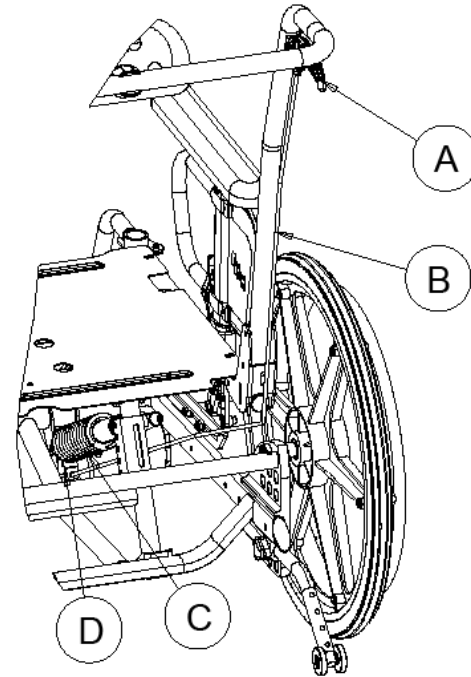

## 8 Adjusting Tilt Angle Settings

### Installing and adjusting center pivot dual swingaway leg rests [Figure 7]

1. To adjust the tilt angle settings one must first place the chair in the nominal 'zero' position where the angle of the seat is approximately 3 degrees. Then remove the 10/32 cap screw and 10/32 lock nut holding the tilt stop upper tube and lower tube in place as shown in Figure 6a.
2. Place the cap screw in the hole shown in Figure 7 to allow the chair to tilt to the approximate angle (16°, 19°, 22°, 24°, 26° or 28°).
3. Insert the 10/32 lock nut in order to hold the 10/32 screw in place.
4. Repeat for other side of chair and ensure the hole chosen for tilt stop is the same on both sides in order to prevent wheelchair problems.

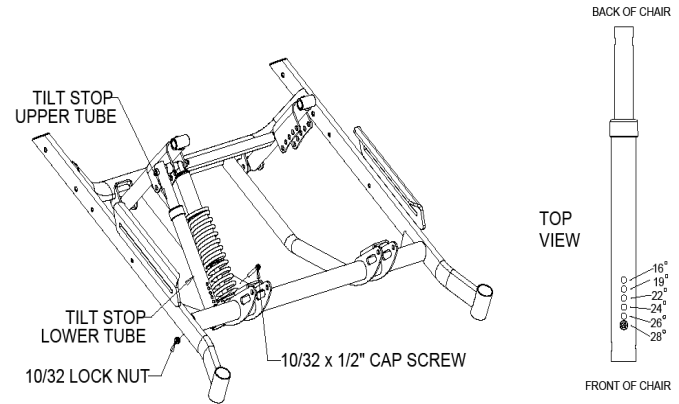

**Figure 7**

## 9 Rear Wheels

### Installing and uninstalling the rear wheels [Figure 8, Figure 9]

1. Push in the detent pin ('A') of the quick-release axle ('B') and pull the axle out through the opening in the center of the rear wheel ('C') and shaft spacer ('D').
2. Push in the detent pin of the quick-release axle again and pull the axle out of the rear wheel and shaft spacer.
3. To reinstall the rear wheel onto the wheelchair, reverse steps 1 to 2.
4. If using the Push-to-Lock or Pull-to-Lock mechanism ensure the wheel locks properly. See the section ADJUSTING THE WHEEL LOCKS.

Note: Make sure the detent pin and locking pins of the quick-release axle are fully released BEFORE operating the wheelchair.

The locking pins MUST be protruding past the inside of the rear wheel axle bushing for a positive lock. Keep locking pins clean.

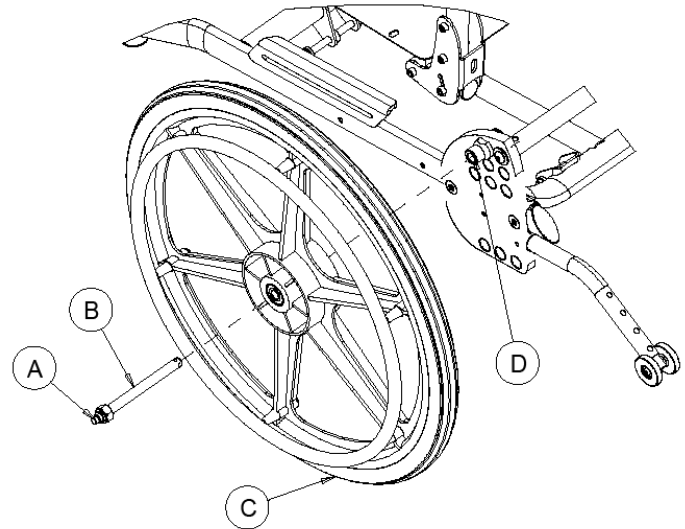

Future Mobility Healthcare Inc. recommends inserting quick-release axles with the detent pin to the inside of the wheelchair to prevent accidental release during contact activities.

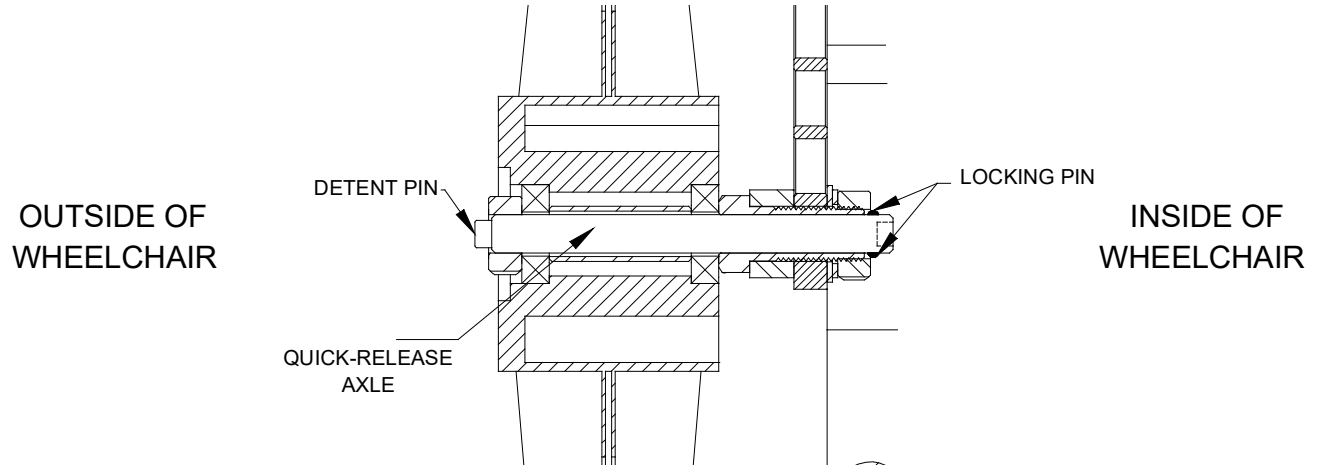

Figure 9

## 10 Wheel Locks

### Applying and Adjusting Wheel Locks[Figure 10, Figure 11]

#### Engaging and Disengaging wheel locks

1. Ensure the wheelchair is not moving before engaging the wheel locks.
2. Perform one (1) of the following:
  - a. Push-to-Lock – to engage, push the wheel lock handle ('A') forward
  - b. Pull-to-Lock – to engage, pull the wheel lock handle ('A') backward
3. Disengage the wheel locks by reversing STEP 2.

#### Adjusting Wheel locks position

1. Disengage the wheel locks ('A').
2. Loosen the two (2) locknuts which hold the wheel lock link 1 ('B') shown in the above figure that secure the wheel lock to the wheelchair frame.

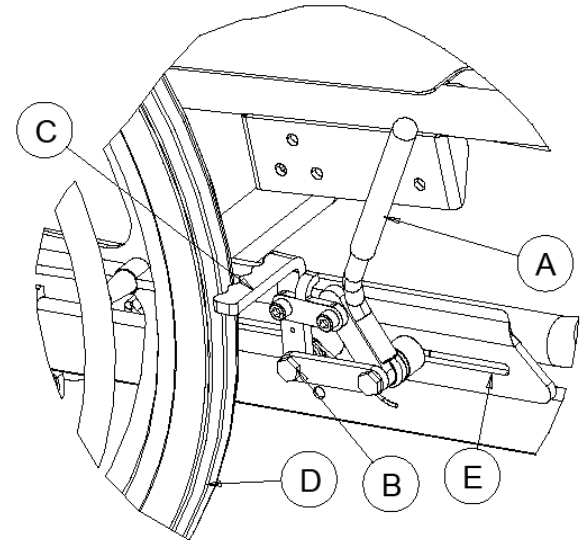

**Figure 10**

3. Reposition the wheel lock along the brake mount plate ('E') so that when engaged, the wheel lock brake shoe ('C') embeds the tire ('D') 1/8" (3/16" for pneumatic tires) and **HOLDS** the occupied wheelchair in place when pushed.
4. Securely tighten the two locknuts securing the wheel lock to the wheelchair frame.
5. Engage the wheel lock.
6. Measure the distance the wheel lock is embedded into the tire
7. Repeat STEPS 1 to 6 until the wheel lock brake shoe embeds the tire and **HOLDS** the occupied wheelchair in place when pushed.
8. Engage both wheel locks and ensure the occupied wheelchair is held in place when pushed.

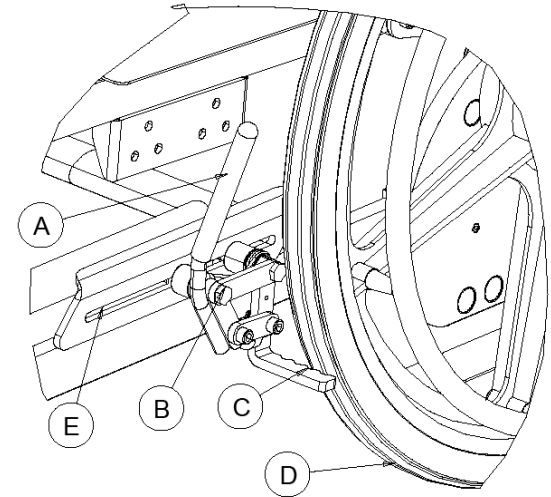

**Figure 11**

## 11 Gas Spring Settings

### Adjusting weight settings on gas springs [Figure 12, Figure 13]

1. To adjust the weight setting on the chair remove the .312 x 2.5" long shoulder bolt and 1/4-20 lock nut connecting the Gas Spring to the Rear H-Link. – see Figure 12
2. Rotate both the Tilt Stop Assembly and Gas Cylinder Assembly to the proper hole depending on the weight of the occupant ( 250 lbs, 350 lbs or 450 lbs) – see Figure 12
3. This should be performed on both sides of the chair and ensure the holes selected on each side are the same in order to prevent wheelchair problems.
4. Insert the .312 x 2.5" long shoulder bolt and 1/4-20 lock nut to secure the Tilt Stop Assembly and Gas Cylinder Assembly to the wheelchair.

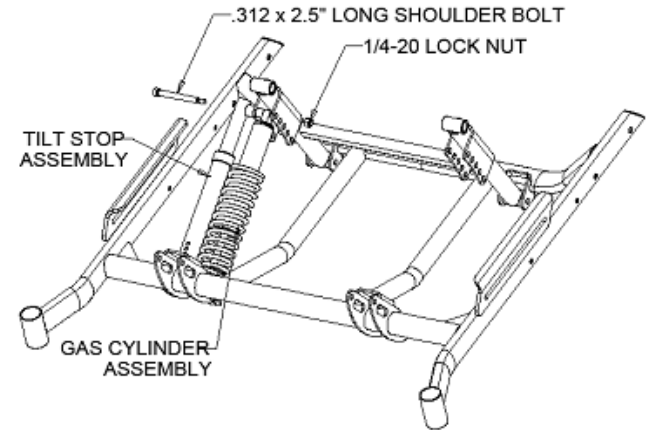

Figure 12

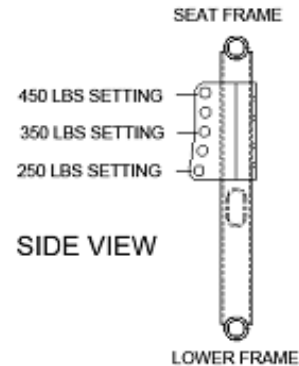
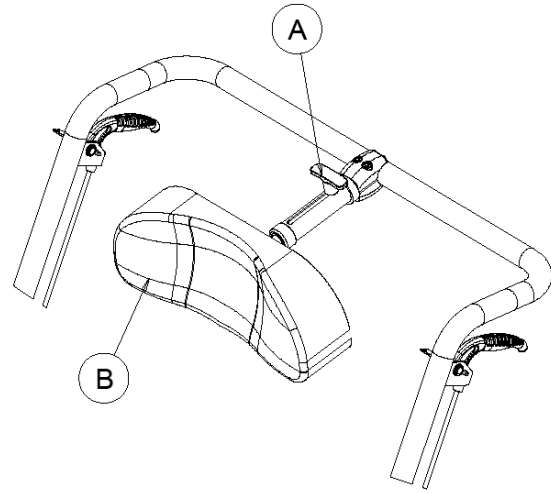

Figure 13

## 12 Head Rest

### Adjusting the headrest [Figure 14]

1. To adjust the headrest location horizontally, turn the t-handle assembly ('A') counter clockwise to loosen the headrest from its current position.
  2. Gently grasp the headrest ('B') and either move it inwards or outwards depending on needs of the end user.
  3. When the desired position is obtained turn the t-handle assembly clockwise to 'lock' the headrest in position.
- 



**Figure 14**



### 13 Casters and Forks

#### Replacing and Installing Front Casters [Figure 15, Figure 16, Figure 17, Table 1]

##### **Installing and replacing the Casters [Figure 15]**

1. Remove the nut, bolt and spacers which secure the caster to the fork assembly.
2. Remove the front caster.
3. Slide in the new 5, 6 or 8 inch front caster into the space between the forks.
4. Tighten the nut, bolt and spacers to secure the caster into place.
5. Repeat this procedure for the other front caster wheel assembly if required.
6. To properly tighten caster journal system and guard against flutter, perform the following check:
  - a. Tip back of wheelchair to floor
  - b. Pivot both forks and casters to top of their arc simultaneously.
  - c. Let casters drop to bottom of arc (wheels should swing once to one-side, then immediately rest in a straight downward position).
7. Adjust locknuts according to freedom of caster swing.
8. Test wheelchair for maneuverability.
9. Re-adjust locknuts if necessary and repeat STEPS 6 to 7 until correct.
10. Snap dust cover over the locknut and stem.

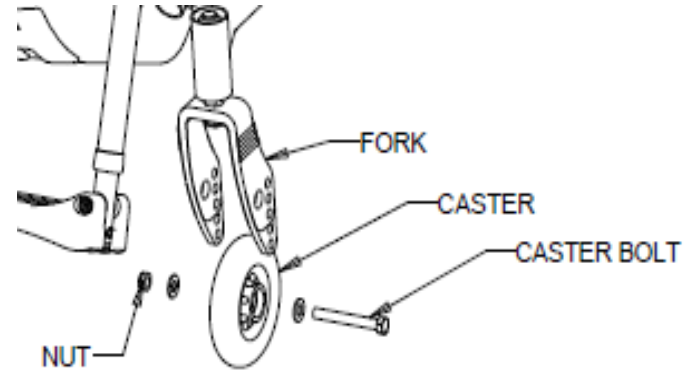

**Figure 15**

### Installing and replacing the front forks [Figure 16]

1. Remove the locknut ('A') which secures the caster stem bolt ('D') to the caster housing ('E').
2. Drop the front caster and fork assembly out of the caster housing.
3. Remove the locknut ('B') which secures the caster stem to the fork ('C')
4. Follow REPLACING/INSTALLING FRONT CASTERS guide in this section to remove the front caster from the fork assembly.
5. Place the caster in the new fork and assemble with the caster nut and bolt and spacer.
6. Secure the new fork and caster assembly in place by using the locknut and caster stem bolt.
7. Follow steps 5 to 9 of REPLACING/INSTALLING FRONT CASTERS guide to properly install the new fork assembly and prevent fluttering.

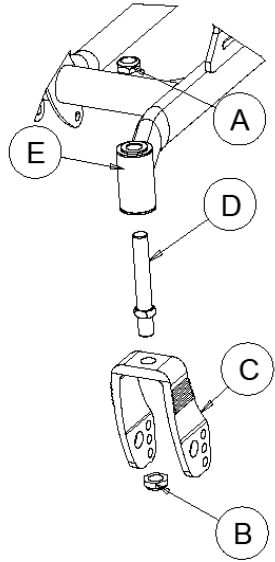

**Figure 16**

## Seat to Floor height

1. Follow the values in the table below to achieve the desired seat to floor height
2. Ensure that no weight is on the wheelchair while performing the operations
3. Ensure after changing the seat to floor height that the wheelchair is still operational and that no wheel flutter or instability occurs.
4. For a weight capacity up to 350 lbs. one can use 20", 22" or 24" rear wheel. For weight capacities above 350lbs one should use 20" or 12" rear wheels. The wheel should be inserted in the middle hole on the axle plate to achieve the seat to floor heights listed below. In case the user requires more stability the wheel can be inserted in the hole furthest to the back of the chair and if the user requires more maneuverability then the wheel can be inserted in the hole closest to the front of the chair.

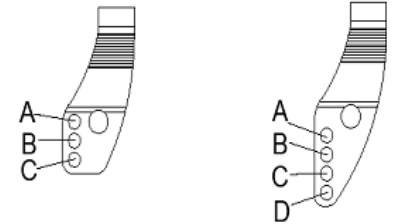
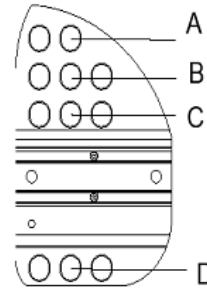

**Figure 17**

<b>STF</b>	<b>REAR</b>	<b>CASTER</b>	<b>FORK</b>	<b>FORK</b>	<b>AXLE PLATE</b>	<b>STF</b>
<b>FRONT (in)</b>	<b>WHEEL (in)</b>	<b>SIZE (in)</b>	<b>SIZE</b>	<b>HOLE</b>	<b>HOLE</b>	<b>REAR (in)</b>
15.875	12	6	Short	C	D	14.875
16.375	12	5	Long	D	D	14.875
15.375	20	5	Short	C	B	14.00
16.00	20	6	Short	C	C	15.00
15.75	22	5	Long	A	C	14.00
16.25	22	6	Long	C	B	15.00
17.75	22	8	Long	D	C	16.00
16.25	24	5	Long	D	A	15.00
16.75	24	6	Long	D	A	15.00
18.00	24	8	Long	D	C	17.00

**Table 1**

## 14 **Anti-tippers**

### **Installing and adjusting the anti-tippers [Figure 18]**

Anti-tippers are specific to the different seat-to floor angles and/or seat-to-floor heights. Refer to Table 1 in the section 13 of the manual for correct usage and adjustment. If these requirements **CANNOT** be achieved, **DO NOT** use the wheelchair. Contact a qualified technician. If changing the seat-to-floor height with or without a change to seat-to-floor angle, the correct anti-tippers **MUST** be used to maintain a 1 ½" to 2" ground clearance.

Seat-to-floor angle of 3 degrees to 6 degrees: if so equipped, anti-tippers **MUST** be attached at all times. In as much as the anti-tippers are an option on this wheelchair (you may order with or without the anti-tippers), Future Mobility Healthcare Inc. strongly recommends ordering the anti-tippers as a safeguard for the wheelchair user.

Anti-tippers **MUST** be fully engaged and snap buttons fully protruding out of adjustment holes.

Ensure both anti-tippers are adjusted to the same mounting hole.

## Installing the anti-tippers

1. Insert the Anti-tip assembly into the rear part of the axle plate with the anti-tipper wheels pointing toward the ground/floor until anti-tip assembly is snug in place. Hold the anti-tip assembly in place by using a release knob plunger assembly
2. Measure the distance between the bottom of the anti-tipper wheels and the ground/floor.
3. If the distance between the bottom of the anti-tipper wheels and the ground/floor is not 1 ½ "to 2", adjust the anti-tippers. Refer to ADJUSTING THE ANTI-TIPPERS in this section of the manual.
4. Repeat steps 1-3 for other anti-tip assembly.
5. Ensure the anti-tip assembly is 'locked' in place so the wheelchair can operate safely.

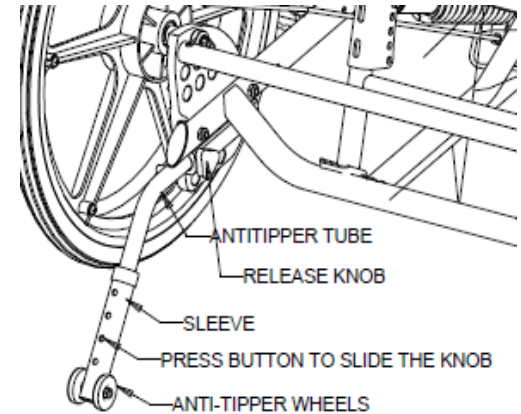

**Figure 18**

**Note:** A 1 ½ "to 2" clearance between the bottom of the anti-tipper wheels and the ground/floor **MUST** be maintained at all times.

## Adjusting the anti-tippers

1. Press the snap button on the anti-tip assembly and adjust the anti-tip slide tube up or down until a 1 ½" to 2" clearance from the ground is achieved.
2. Check to make sure that the snap buttons are fully engaged in the adjustment holes.

## **15 Cleaning Instructions**

### **Seat and Back**

- Remove the outer and inner cover if required and hand wash with a small amount of detergent
  - Hang to dry, do not machine dry or wring out
- Use multipurpose disinfectant to spray seat, scrub with soft brush.
  - Test an inconspicuous area first for colour-fastness
- **DO NOT USE HOT AIR FOR DRYING.**
- **DO NOT IMMERSE** the cushion or back foam in water or cleaning solution.
- Some colour leeching from the cover and dyeing the foam is normal and cannot be washed out

### **Frame, Armrest, Footrests And Other Components**

- Spray the frame and components with multi-purpose disinfecting detergent, scrub with **soft** brush.
- Rinse well and dry with a soft cloth.
- **DO NOT USE HOT AIR FOR DRYING.**

By wiping down with a soft cloth after rinsing mildew buildup will be minimized.

**IMPORTANT:** DO NOT USE ABRASIVE POWDERS OR SCOURING PADS ON PAINTED SURFACES

- DO NOT SUBMERGE CHAIR IN WATER
- RINSE WITH A DAMP RAG AFTER CLEANING TO ENSURE THAT ANY SOAP RESIDUE IS REMOVED
- DO NOT USE CLEANING PRODUCTS WITHOUT CONSULTING THE PRODUCTS' INSTRUCTIONS AND TAKING APPROPRIATE PRECAUTIONS FOR HUMAN EXPOSURE TO CHEMICALS

## **16 Warranty**

This warranty is extended only to the original purchaser/user of our products.

Future Mobility Healthcare Inc. ("FMHI"). warrants its Orion II 500 Wheelchair parts and miscellaneous components for a period of one year from date of purchase to be free from defects in material and workmanship. The frame is warranted for the lifetime of the original purchaser/user. The Orion II 500 back is warranted for two (2) years and the upholstery for 90 days, upon normal usage by original purchaser. If within this warranty period the product shall be proven to be defective, such product shall be repaired or replaced, at FMHI discretion. FMHI's sole obligation and your exclusive remedy under this warranty shall be limited to the repair and/or replacement of the product or its parts. This warranty does not include any labour or shipping charges incurred in replacement part installation or repair of any product.

For warranty service, please contact the dealer from whom you purchased your FMHI product. In the event you do not receive satisfactory warranty service, please write directly to FMHI. Provide the dealer's name, address, model number, date of purchase and indicate the nature of the defect.

DO NOT return products to FMHI without our prior consent. The defective unit or parts must be returned for warranty inspection within thirty (30) days of the return authorization date. (FMHI will issue a return authorization number). Please prepay all shipping charges; C.O.D. shipments will be refused.

LIMITATIONS and EXCLUSIONS: This warranty shall not apply to problems arising from normal wear or failure to adhere to the enclosed instructions. Products subjected to negligence, accident, improper usage, maintenance or storage; or products modified without FMHI written consent including, but not limited to: modification through the use of any unauthorized parts or attachments; products damaged by reason or repairs made to any component without the specific consent of FMHI, or products repaired by anyone other than a FMHI dealer. Such evaluation shall be determined by FMHI.

The foregoing warranty is exclusive and in lieu of all other expressed warranties. It shall not extend beyond the duration of the expressed warranty provided herein and the remedy for violations of any implied warranty shall be limited to repair or replacement of the defective product pursuant to the terms contained herein. FMHI shall not be liable for any consequential or incidental damages whatsoever.



-----  
Cut below this line #**Warranty Registration Form**

To validate your Future Mobility HealthCare warranty, please complete the below form and return it the address at the end of this form. Visit online at [www.futuremobility.ca](http://www.futuremobility.ca) for more Future Mobility Products.

Name: \_\_\_\_\_

Street Address: \_\_\_\_\_

City/Country/Postal Code: \_\_\_\_\_

Telephone: \_\_\_\_\_

Purchased Date: \_\_\_\_\_

Purchased From (Dealer Name &amp;

Address): \_\_\_\_\_

Product Purchased: \_\_\_\_\_

Serial Number: \_\_\_\_\_

**Print and Mail it to:**  
**Future Mobility Healthcare Products**  
**6750 Professional Court**  
**Mississauga, Ontario, L4V 1X6**  
**Fax: 905-671-3377**

## **CANADA**

**Future Mobility Healthcare Inc.**  
6750 Professional Court  
Mississauga, ON L4V 1X6  
**Ph:** 905 671-1661 –Toll Free: 1 888 737-4011  
**Fax:** 905 671-3377  
**Toll Free Fax:** 1-866-670-3377  
**e-mail:** customerservice@futureamobility.ca  
**www.futuremobility.ca**



**FUTURE MOBILITY**  
INNOVATIVE SEATING AND HOME MOBILITY SOLUTIONS

## **USA**

**Future Mobility Products US LLC**  
1 Buffalo River Place  
Buffalo, NY, 14210  
**Tel:** 716-783-9130 –Toll Free 1-855-938-  
898873  
**Fax:** 716-783-9236  
**Toll Free Fax:** 1-866-670-3377  
**e-mail:** customerservice@futureamobility.ca  
**www.futuremobility.ca**



**FUTURE MOBILITY**  
PRODUCTS

